



MD4104 MD4102-CEB47 MD4101-CB47 MD4101-CB72 MD4101-CB700 MD4102-HCE47 MD4101-HCB47 MD4101-HCB700 MD4101-HCB1000 MD4101-CF1500

**MD4104 34" Chromed Olympic Bar**

- 01 CHROME SLEEVE
  - 02 CHROME SHAFT
  - 03 PU END CAP
- WEIGHT:12kgs  
SHAFT DIAMETER:28mm  
BUSHING:2pcs copper ring and 2pcs ball bearing  
CAPACITY:300kgs

**MD4102-CEB47 122cm Chromed EZ Curl Olympic Bar**

- 01 CHROME SLEEVE
  - 02 CHROME SHAFT
  - 03 PU END CAP
- WEIGHT:9kgs  
SHAFT DIAMETER:28mm  
BUSHING:2pcs copper ring and 2pcs ball bearing  
CAPACITY:150kgs

**MD4101-CB47 122cm Chromed Olympic Bar**

- 01 CHROME SLEEVE
  - 02 CHROME SHAFT
  - 03 PU END CAP
- WEIGHT:8.8kgs  
SHAFT DIAMETER:28mm  
BUSHING:2pcs copper ring and 2pcs ball bearing  
CAPACITY:150kgs

**MD4101-CB700 220CM Chromed Olympic Bar**

- 01 CHROME SLEEVE
  - 02 CHROME SHAFT
  - 03 PU END CAP
- WEIGHT:20kgs  
SHAFT DIAMETER:30mm  
BUSHING:2pcs copper ring and 2pcs ball bearing  
CAPACITY:700lbs-318kgs

**MD4101-CB72 183CM Chromed Olympic Bar**

- 01 CHROME SLEEVE
  - 02 CHROME SHAFT
  - 03 PU END CAP
- WEIGHT:15kgs  
SHAFT DIAMETER:28mm  
BUSHING:2pcs copper ring and 2pcs ball bearing  
CAPACITY:150kgs

**MD4101-CF1500 220CM Hard Chromed Olympic Bar**

- 01 HARD CHROME SLEEVE
  - 02 BLACK OXIDE SHAFT
  - 03 ALLOY STEEL SHAFT
- WEIGHT:20kgs  
SHAFT DIAMETER:28mm  
BUSHING:2pcs copper ring and 4pcs needle bearing  
CAPACITY:1500lbs-680kgs

**MD4102-HCE47 122cm Hard Chromed EZ Curl Olympic Bar**

- 01 HARD CHROME SLEEVE
  - 02 HARD CHROME SHAFT
- WEIGHT:10kgs  
SHAFT DIAMETER:30mm  
BUSHING:2pcs copper ring and 2pcs needle bearing  
CAPACITY:150kgs

**MD4101-HCB47 122cm Hard Chromed Olympic Bar**

- 01 HARD CHROME SLEEVE
  - 02 HARD CHROME SHAFT
- WEIGHT:10kgs  
SHAFT DIAMETER:30mm  
BUSHING:2pcs copper ring and 2pcs needle bearing  
CAPACITY:150kgs

**MD4101-HCB700 220CM Hard Chromed Olympic Bar**

- 01 HARD CHROME SLEEVE
  - 02 HARD CHROME SHAFT
- WEIGHT:20kgs  
SHAFT DIAMETER:30mm  
BUSHING:2pcs copper ring and 4pcs needle bearing  
CAPACITY:700lbs-318kgs

**MD4101-HCB1000 220CM Hard Chromed Olympic Bar**

- 01 HARD CHROME SLEEVE
  - 02 HARD CHROME SHAFT
- WEIGHT:20kgs  
SHAFT DIAMETER:30mm  
BUSHING:2pcs copper ring and 4pcs needle bearing  
CAPACITY:1000lbs-454kgs

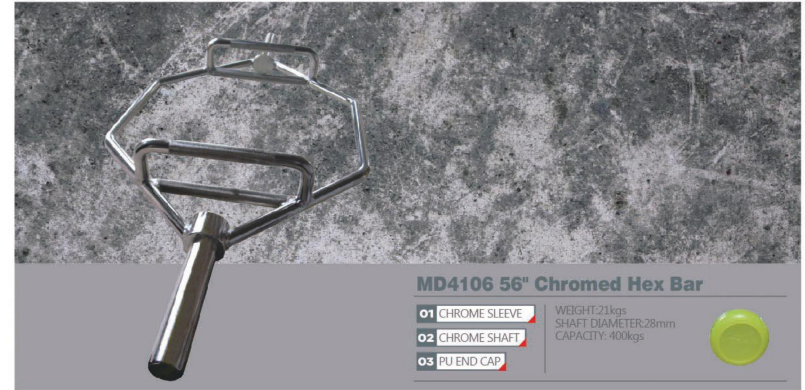
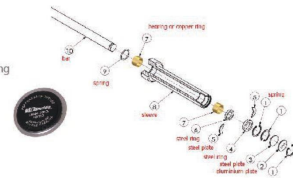

**MD4106 56" Chromed Hex Bar**

- 01 CHROME SLEEVE
  - 02 CHROME SHAFT
  - 03 PU END CAP
- WEIGHT:21kgs  
SHAFT DIAMETER:28mm  
CAPACITY:400kgs

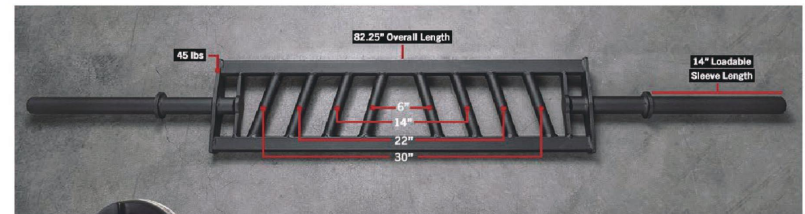

**MD4113 Multi Grip Bars-Black**

- 01 MULTI GRIP
  - 02 BLACK PAINTED
- SHAFT DIAMETER:28mm  
CAPACITY:400kgs

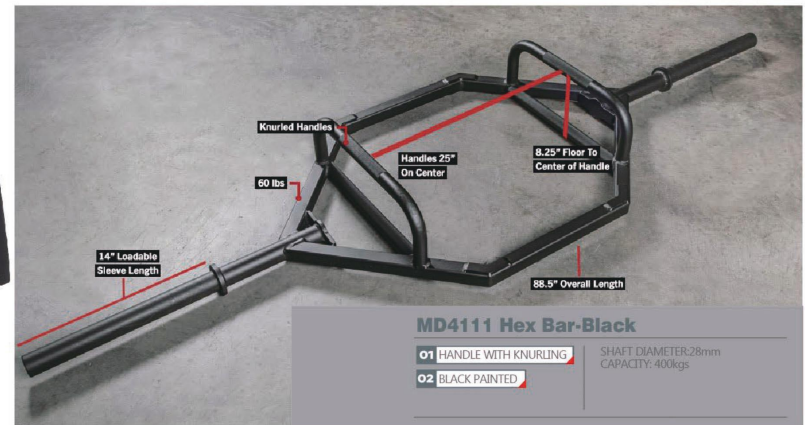

**MD4111 Hex Bar-Black**

- 01 HANDLE WITH KNURLING
  - 02 BLACK PAINTED
- SHAFT DIAMETER:28mm  
CAPACITY:400kgs

MD4108 GREY HAMMER TONE HEX DUMBBELL

- Aluminium Bar with Copper Ring
- Chromed/Hard Chromed steel sleeve
- L180cm, D-25mm, 8kgs/PC
- Color: black/red/gold/rose color/silver



MD4114 CHILDREN BAR

- Aluminium handle and sleeve, with copper ring
- 122cm, D-25mm, 2.2kgs
- Color: black/red/gold/rose



MD4220 PP BAR

- With collars
- Two sections could link to one barbell bar



MD4201 14"/16"REGULAR THREADED BAR

- Diameter: 25/28/30mm



MD4202 14"/16"REGULAR RUBBER HANDLE BAR

- With Star Collars And Rubber Handle



MD4206 14"/16" T ABS BAR

- Diameter: 25/28/30mm



MD4208 1"X 1300MM BLACK(MATT) HOLLOW BAR

- Diameter: 25/28/30mm



MD4209 30MM\*1400MM CHROMED HOLLOW BAR

- Diameter: 25/28/30mm
- With Black Foam



MD4210 30MM\*1400MM BLACK HOLLOW BAR

- With Black Foam
- With Spring Collars
- Diameter: 25/28/30mm



MD4211 47"/60"/66"/72"/86"REGULAR BAR

- With Star Collars
- Diameter: 25/28/30mm



MD4212 47"/60"/66"/72"/86"REGULAR BAR

- Diameter: 25/28/30mm



MD4213 47" EZ CURL BAR

- With Star Collars
- Diameter: 25/28/30mm

MD4214 47" EZ CURL BAR

- Diameter: 25/28/30mm



MD4215 47" SUPER CURL BAR

- With Star Collars
- Diameter: 25/28/30mm

MD4216 47" SUPER CURL BAR

- Diameter: 25/28/30mm



MD4217 34" TRICEP BAR

- With Star Collars
- Diameter: 25/28/30mm

MD4218 34" TRICEP BAR

- Diameter: 25/28/30mm





MD5001	•Revolving 26" Lat Bar
MD5002	•Revolving 38" Lat Bar
MD5003	•Revolving 20" Straight Bar
MD5004	•Revolving 28" Curl Bar
MD5005	•Revolving 48" Lat Bar

MD5006	•Revolving Multi Exercise Bar
MD5007	•Narrow Pull-down Bar
MD5008	•Tricep Press Down Bar
MD5009	•Single Grip Handle w/Rotating Handle
MD5009A	•Single Grip Handle w/Rotating Handle
MD5010	•Chromed Low Pulley Bar
MD5010A	•Chromed Low Pulley Bar
MD5011	•Single Grip Handle
MD5011A	•Single Grip Handle
MD5011B	•Single Grip Handle

MD5012	•Revolving 28" Lat Bar
MD5013	•Revolving 38" Lat Bar
MD5014	•Multi-use Lat Bar
MD5015	•Revolving 34" Lat Bar
MD5016	•Revolving 24" Lat Bar

MD5017	•Lat Bar
MD5018	•Revolving 48" Lat Bar
MD5019	•Revolving 48" Lat Bar
MD5020	•Revolving 48" Lat Bar-hollow
MD5021	•48" Lat Bar
MD5022	•Revolving 20" Straight Bar
MD5023	•Revolving 14" Straight Bar
MD5024	•Revolving 12" Straight Bar

MD5025		MD5025	•Revolving 18" Straight Bar
MD5026		MD5026	•18" Straight Bar with Solid Core, TPR handle
MD5027		MD5027	•Revolving 18" Straight Bar
		MD5028	•18" Straight Bar with Solid Core, TPR handle
		MD5029	•14" Straight Bar-solid core, TPR handle
		MD5030	•Revolving 28" Curl Bar, TPR handle
		MD5031	•Revolving 28" Curl Bar
		MD5032	•Multi Purpose V-Bar
		MD5033	•Revolving Press Down Bar
		MD5034	•Revolving Multi Exercise Bar
		MD5035	•Revolving Tricep Press Down Bar
		MD5036	•Tricep Press Down Bar
		MD5037	•Revolving Pulldown Bar
		MD5038	•Revolving Pulldown Bar
		MD5039	•Single Grip Handle w/Rotating Handle
		MD5040	•Chromed Low Pulley Bar
		MD5041	•Chromed Low Pulley Bar
		MD5042	•Narrow Pulldown Bar

MD5043		MD5043A		MD5044	
MD5045		MD5046			
MD5047		MD5048			
MD5049		MD5050			
MD5051		MD5052			
MD5053		MD5054			
MD5055					

MD5043	•Triceps Rope
MD5043A	•Triceps Rope
MD5044	•Single Rope
MD5045	•Revolving 38" Lat Bar, TPR handle
MD5046	•Revolving 24" Lat Bar, TPR handle
MD5047	•Tricep Press Down Bar, TPR handle
MD5048	•Revolving Multi Exercise Bar, TPR handle
MD5049	•Revolving Press Down Bar, TPR handle
MD5050	•Multi Purpose V-Bar, TPR handle
MD5051	•Revolving 36"/48" Lat Bar, Chromed, TPR handle
MD5052	•Single Grip Handle w/Rotating Handle
MD5053	•Low Pulley Bar, TPR handle
MD5054	•Revolving 38" Curl Bar, TPR handle
MD5055	•Revolving 20" Straight Bar, TPR handle

- MD5045A •Revolving 38" Lat Bar, Nickel finished with PU handle
- MD5046A •Revolving 24" Lat Bar, Nickel finished with PU handle
- MD5047A •Tricep Press Down Bar, Nickel finished with PU handle
- MD5048A •Revolving Multi Exercise Bar, Nickel finished with PU handle
- MD5049A •Revolving Press Down Bar, Nickel finished with PU handle
- MD5050A •Multi Purpose V-Bar, Nickel finished with PU handle
- MD5051A •Revolving 36" /48" Lat Bar, Nickel finished with PU handle
- MD5052A •Single Grip Handle w/Rotating Handle, Nickel finished with PU handle
- MD5053A •Low Pulley Bar, Nickel finished with PU handle
- MD5054A •Revolving 38" Curl Bar, Nickel finished with PU handle
- MD5055A •Revolving 20" Straight Bar, Nickel finished with PU handle



MACHINE BARS



**MD5056 BARBELL PAD**  
 •Size: 40x8.5x8cm/250g  
 •Meas: 50pcs/ctn, 61x42x52cm  
 •N.W./G.W.: 10/11kgs



**MD5057 LIFTING STRAPES**  
 •Size: 380(L)mm  
 •Strong straps that wrap around bar and wrists aid in grip strength during heavy lifting.



**MD5058 AB STRAPE WITH D RING**  
 •Size: L38xW19.5cm, D ring-L14cm, 373g/pc  
 •Meas: 50pcs/ctn, 48x32x38cm  
 •N.W./G.W.: 19/20kgs



**MD5060 CHROMED LIFTING CHAINS**  
 •Length: 150cm  
 •Optional weight: 5/10/15/20/30kgs  
 •Lifting chains provide a great workout, always sale per pair.

**MD5061 ROPE WALL MOUNT**  
 •Ring: D12mm & 6mm T plate,  
 •Size: L33cm x W5cm x H13.5cm, 1.1kg per pc  
 •Meas: 10pcs/ctn, 34x33x34cm  
 •N.W./G.W.: 10/11kgs

**MD5062 BATTING ROPE ANCHOR**  
 •Size: 6mm T & 5mm T Plate, 40mm x80mm x1.5mm T Tubing, 1.80 kg/pc  
 •Meas: 10pcs/ctn, 66x44x33cm  
 •N.W./G.W.: 17/18kgs

**MD5063 TRUNK BLASTER**  
 •Single Tube: 63.5mm OD x 6mm T (51.5mm ID) & 25mm D x 2mm T,  
 1.5kg per pc, black color  
 •Meas: 10pcs/ctn, 41x32x31cm  
 •N.W./G.W.: 15/16kgs

**MD5064 TRUNK BLASTER**  
 •Double tube: 63.5mm OD x 6mm T (51.5mm ID) & 25mm D x 3mm T & 30mm D x 3mm T, 3.50 kg, black  
 •Meas: 10pcs/ctn, 41x32x31cm  
 •N.W./G.W.: 35/36kgs

**MD5065 TRUNK BLASTER**  
 •Double D-25mm tube of the handle,  
 D-63.5mm x T-6MM of the middle hole, black, 4.8kg per pc  
 •Meas: 10pcs/ctn, 69x49x20cm  
 •N.W./G.W.: 48/49kgs





MD5066



MD5067



MD5071

**MD5072 TRAINING TIMER**

- Packing: 1pc per brown box
- Meas: 80x54x24cm/5sets
- N.W./G.W: 18/23kgs



**MD5096 TRAINING TIMER**

- Packing: 1pc per brown box
- Meas: 80x54x24cm/5sets
- N.W./G.W: 18/23kgs



MD5074

**MD5086 AYLON HEAD HAMNESS**

- with flocked cloth and 60cm chains, 7mm thick of EVA foam, high density straps
- Meas: 10pcs/ctn, 69x49x20cm
- N.W./G.W: 48/49kgs

**MD5067 TRAIN HARD DIPPING**

- with flocked cloth and 60cm chains
- Size: 44.5x16.5cm, 554g per pc
- Meas: 20pcs/ctn, 50x35x20cm
- N.W./G.W: 12/13kgs

**MD5089 INVERSION BOOT**

- Size: 2.7kg/pr
- Meas: 38x20x22cm/pr
- N.W./G.W: 2.7/3.7kgs

**MD5073 ANKLE CUFF**

- Meas: 41x54x24cm/50pcs
- N.W./G.W: 8.4/9.4kgs



MD5081



MD5069



MD5073

**MD5071 TRAIN HARD DIPPING MATERIAL**

- Material: leather
- Size: 85\*16\*2cm, 720g per pc
- Meas: 50x40x30cm/20pcs
- N.W./G.W: 14/16kgs

**MD5074 ATTACHMENT FOR ACCESSORY SET BAND**

- Door Anchor 1PC, handle 2pcs, loop band 1pc

**MD5077 SILICA GRIPZ**

- Size: 100x50cm, 323g/pr
- 125x50cm, 417g/pr
- Meas: 41x33.5x30.5cm/50prs
- N.W./G.W: 15.5/16.5kgs

**MD5081 HANDLE GRIP**

- Material: silica gel
- Weight: 175g/pc
- Diameter: 2mm
- Packing: 1pr/box
- Meas: 20prs/ctn, 37x30x30cm
- N.W./G.W: 7.5/8.5kgs

**MD5083 MARKED GRASS FOR SLED**

- Material: PE
- Size: L1020xW200cm,
- Color: green and white
- Meas: 0.38cm/roll
- N.W./G.W: 81/83kgs



**MD5084 MARKED GRASS FOR TRAINING**

- Material: PE
- G.S: L770\*W420cm (N.S.: L750\*W400cm)
- Color: green and white
- Meas: 0.38cm/roll
- N.W./G.W: 57/59kgs

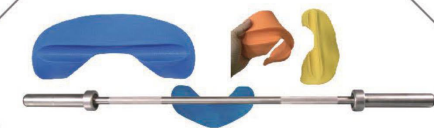
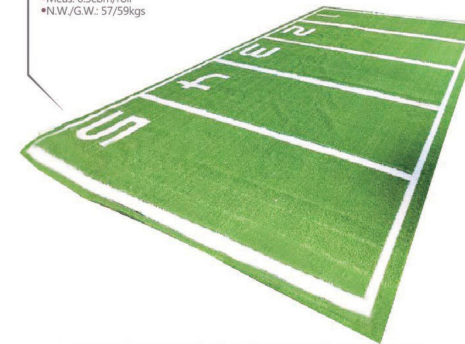

MD5079

**MD5075 CHROMED HANDLE FOR POWER LOOP**

- Size: 100x50cm, 323g/pr
- 125x50cm, 417g/pr
- Meas: 41x33.5x30.5cm/50prs
- N.W./G.W: 15.5/16.5kgs

**MD5086 ANKLE ACCESSORY**

- Material: 1cm foam, thicker lamb wool, 7.5cm strap, 5cm D ring
- Size: 30\*8cm (strap total length\*width)

**MD5079 TPR BAR PAD**

- Weight: 365g/pc
- Length: 32cm
- Common color: orange, blue, yellow

**MD5085 GYM STRAPS WITH NEOPRENE (BLACK BAND)**

- Size: 21" x 1.5"
- Material: polyester cotton



MD5086



MD5075



MD5086



MD5079

 <p>MD5088</p>  <p>MD5093</p>	
 <p>MD5087</p>  <p>MD5082</p>	
 <p>MD5089</p>	
 <p>MD5090</p>  <p>MD5091</p>	
 <p>MD5092</p>	
<p><b>MD5082 MEDICINE BALL HARNESS WITH ROPE (EXCLUDING MEDICINE BALL)</b></p> <ul style="list-style-type: none"> <li>• Used for 1-10kg medicine ball</li> <li>• Meas: 25pcs/ctn, 46x36x36cm</li> <li>• N.W./G.W.: 11/11.5kgs</li> </ul>	
<p><b>MD5088 BMI CALCULATOR</b></p> <ul style="list-style-type: none"> <li>• Size: Belt length-150cm, width-1.4cm</li> <li>• Diameter is 7.2cm, thickness is 2.5cm</li> </ul>	
<p><b>MD5093 SHAKE CUP WITH STEEL BALL</b></p> <ul style="list-style-type: none"> <li>• Size: 500ml</li> <li>• Material: PP</li> <li>• Meas: 48pcs/ctn, 54x38x36cm</li> <li>• N.W./G.W.: 8.5/9.5kgs</li> </ul>	
<p><b>MD5087 AB STRAPE FOR TRAINING</b></p> <ul style="list-style-type: none"> <li>• Material: PU-foam+double ensured D ring</li> <li>• Size: L88xW19cm, D ring-L16.5cm</li> <li>• Meas: 50pcs/ctn, 48x32x38cm</li> <li>• N.W./G.W.: 22/23kgs</li> </ul>	
<p><b>MD5089 VEST</b></p> <ul style="list-style-type: none"> <li>• Size: 140x100cm</li> <li>• Material: terylene+SBR</li> </ul> <p><b>MD5090 BELT</b></p> <ul style="list-style-type: none"> <li>• Length: 100cm</li> <li>• Material: terylene+SBR</li> </ul> <p><b>MD5091 ANKLE ACCESSORY</b></p> <ul style="list-style-type: none"> <li>• Material: terylene+SBR</li> </ul> <p><b>MD5092 HANDLE</b></p> <ul style="list-style-type: none"> <li>• Material: terylene+SBR</li> <li>• Strap width: 3.8cm</li> </ul> <p><b>MD5095 LIFTING STRAPS</b></p> <ul style="list-style-type: none"> <li>• Size: 15*39cm</li> </ul>	

 <p>MD6101</p>  <p>MD6102</p>	 <p>MD6104</p>  <p>MD6105</p>
 <p>MD6103</p>	 <p>MD6107</p>
<p><b>MD6101 1" PLATE STORAGE RACK</b></p> <ul style="list-style-type: none"> <li>• Main Tube: 40x60x1.5mm</li> <li>• Packing: 1pc/ctn</li> <li>• Meas: 94x74x13cm N.W./G.W.: 10.5/12.5kgs</li> </ul> <p><b>MD6102 2" PLATE STORAGE RACK</b></p> <ul style="list-style-type: none"> <li>• Main Tube: 40x60x1.5mm</li> <li>• Packing: 1pc/ctn</li> <li>• Meas: 93x73x13cm</li> <li>• N.W./G.W.: 12/14kgs</li> </ul> <p><b>MD6103 VERTICAL OP PLATE TREE</b></p> <ul style="list-style-type: none"> <li>• Vertical OP Plate Tree</li> <li>• Main Tube: 50x70x2.0mm</li> <li>• Packing: 1pc/ctn</li> <li>• Meas: 104x25x23cm</li> <li>• N.W./G.W.: 18.5/20kgs</li> </ul> <p><b>MD6104 OP PLATE TREE</b></p> <ul style="list-style-type: none"> <li>• Main Tube: 50x70x2.0mm</li> <li>• Packing: 1pc/ctn</li> <li>• Meas: 110x38.5x18.5cm</li> <li>• N.W./G.W.: 36/38kgs</li> </ul> <p><b>MD6105 OP PLATE STORAGE CART</b></p> <ul style="list-style-type: none"> <li>• Main Tube: 50x50x2.0mm</li> <li>• Packing: 1pc/ctn</li> <li>• Meas: 130.5x62x29cm</li> <li>• N.W./G.W.: 23/25kgs</li> </ul> <p><b>MD6106 OP PLATE TREE</b></p> <ul style="list-style-type: none"> <li>• Main Tube: PT50x100x2.0mm Packing: 1pc/ctn</li> <li>• Meas: 132x75x20cm</li> <li>• N.W./G.W.: 20/22kgs</li> </ul> <p><b>MD6107 OP PLATE TREE</b></p> <ul style="list-style-type: none"> <li>• Main Tube: 50x70x2.0mm</li> <li>• Packing: 1pc/ctn Meas: 106x73.5x18.5cm</li> <li>• N.W./G.W.: 28/30kgs</li> </ul>	 <p>MD6103</p>  <p>MD6106</p>



MD6108



MD6110



MD6111



MD6112



MD6109

**MD6109 OP PLATE TREE**

- Main Tube:  $\phi 40 \times 80 \times 2 \text{mm}$
- Meas:  $85 \times 55 \times 55 \text{cm}$
- N.W./G.W.:  $26/28 \text{kgs}$

**MD6109 OP PLATE & BAR STORAGE RACK**

- Packing: 1pc/ctn
- Main Tube:  $50 \times 70 \times 2.0 \text{mm}$
- Meas:  $142 \times 108 \times 45.5 \text{cm}$
- N.W./G.W.:  $58/60 \text{kgs}$

**MD6110 OP PLATE TREE**

- Packing: 1pc/ctn
- Meas:  $75 \times 75 \times 106 \text{cm}$
- N.W./G.W.:  $26/28 \text{kgs}$

**MD6111 OP PLATE TREE**

- Main Tube:  $\phi 40 \times 80 \times 2.5 \text{mm}$
- Packing: 1pc/ctn
- Meas:  $77 \times 59 \times 98 \text{cm}$
- N.W./G.W.:  $28/30 \text{kgs}$

**MD6112 FREE-STANDING PLATE & BAR STORAGE**

- Main Tube:  $50 \times 50 \times 2 \text{mm}$
- Packing: 1pc/ctn
- Meas:  $123 \times 55 \times 7.5 \text{cm}$
- N.W./G.W.:  $19.0/21.0 \text{kgs}$



MD6116



MD6114



MD6115



**MD6113 SOFT PLATE HOLDER**

- For bumper plate
- Meas:  $61 \times 38 \times 40 \text{cm}$
- N.W./G.W.:  $13/14 \text{kgs}$

**MD6114 BUMPER PLATE STACKER ON WHEELS**

- Height of bar:  $70 \text{cm}$

**MD6115 BUMPER PLATE RACK**

- Meas:  $145 \times 36 \times 30 \text{cm}$
- N.W./G.W.:  $16/17 \text{kgs}$

**MD6116 OLYMPIC PLATE TREE**

- Meas:  $97 \times 83 \times 22 \text{cm}$
- N.W./G.W.:  $22/24 \text{kgs}$



MD6113



**MD6201 VINYL DUMBBELL STORAGE RACK**

- Main Tube: 50×50×1.5mm
- Meas: 115×72×15cm
- N.W./G.W.: 30/33kgs



**MD6202 VINYL DUMBBELL STORAGE RACK**

- Main Tube: 50×50×1.5mm
- Meas: 112×109×30cm
- N.W./G.W.: 35/37kgs



**MD6203 VINYL DUMBBELL STORAGE RACK**

- Main Tube: 40×80×1.5mm
- Meas: 106×82×32.5cm
- N.W./G.W.: 34/36.5kgs



**MD6204 DUMBBELL STORAGE RACK**

- Main Tube: 50×50×1.5mm
- Meas: A-114×50×31cm, B-112×72.5×33cm
- N.W./G.W.: A-45/47kgs, B-35/38kgs



**MD6205 KETTLEBELL STORAGE RACK**

- Main Tube: 40×60×2mm
- Meas: A-114×30×14cm, B-79×64.5×18cm
- N.W./G.W.: A-24/26kgs, B-12/14kgs



**MD6206 10PRS DUMBBELL STORAGE RACK**

- Main Tube: PT40×80×2mm
- Meas: A-131×28×33cm, B-85×68×44.5cm
- N.W./G.W.: A-24/26kgs, B-61/65kgs



**MD6207A 10PRS DUMBBELL STORAGE RACK**

- Main Tube: PT40×80×2.0mm
- Meas: A-243×25×16cm, B-78×75×25cm
- N.W./G.W.: A-45/47kgs, B-12/14kgs

**MD6207B 10PRS DUMBBELL STORAGE RACK**

- Main Tube: PT50×100×2.0mm
- Meas: A-243×25×16cm, B-78×75×25cm
- N.W./G.W.: A-45/47kgs, B-14/16kgs

**MD6207C 5PRS DUMBBELL STORAGE RACK**

- Main Tube: PT50×100×2.0mm
- Meas: A-124×25×16cm, B-78×75×25cm
- N.W./G.W.: A-25/27kgs, B-14/16kgs

**MD6207D 6PRS DUMBBELL STORAGE RACK**

- Main Tube: PT50×100×2.0mm
- Meas: A-243×25×16cm, B-78×75×25cm
- N.W./G.W.: A-28/30kgs, B-14/16kgs



**MD6208A 6PRS DUMBBELL STORAGE RACK**

- Main Tube: PT40×80×2.0mm
- Meas: A-185×28.5×21cm, B-84.5×67×38cm
- N.W./G.W.: A-23/25kgs, B-22/24kgs



**MD6208 5PRS DUMBBELL STORAGE RACK**

- Main Tube: PT40×80×2.0mm
- Meas: A-132×28.5×21cm, B-84.5×67×38cm
- N.W./G.W.: A-21/23kgs, B-22/24kgs



**MD6209A 5PRS DUMBBELL STORAGE RACK**

- Main Tube: PT50×100×2.5mm, thickness is 3.5mm of the steel board
- Meas: A-130×27×18cm, B-93×68×38cm
- N.W./G.W.: A-24/26kgs, B-28/30kgs

**MD6209B 5PRS DUMBBELL STORAGE RACK**

- Main Tube: PT40×80×2mm, thickness is 2.5mm of the steel board
- Meas: A-130×27×18cm, B-93×68×38cm
- N.W./G.W.: 43/47kgs



**MD6210 3-TIERS DUMBBELL STORAGE RACK**

- Main Tube: PT50×100×2.5mm
- Meas: A-155×53×29cm, B-114×88×38cm
- N.W./G.W.: A-76/79kgs, B-43/46kgs



**MD6211 3-TIERS DUMBBELL STORAGE RACK**

- Main Tube: PT40×80×2.5mm
- Meas: A-150×103×24cm, B-160×24×22cm
- N.W./G.W.: 73/77kgs



**MD6217 / MD6217A 10PRS DUMBBELL STORAGE RACK**

- 1-10kgs
- Main Tube: 50×100×2mm
- Meas: A-142×115×14cm  
B-75×61×11cm
- N.W./G.W.: 30/32kgs
- 2-20kgs
- Main Tube: 50×100×2mm
- Meas: A-175×46.5×16cm  
B-94×69×13cm
- N.W./G.W.: 39/43kgs



**MD6218 6PRS DUMBBELL STORAGE RACK**

- Meas: 86×55×27cm
- N.W./G.W.: 14/15kgs



**MD6212 6PRS DUMBBELL STORAGE RACK**

- Main Tube: 50×50×1.5mm
- Meas: 108×18×14cm
- N.W./G.W.: 14/16kgs



**MD6212A 6PRS DUMBBELL STORAGE RACK WITH RUBBER BASE**

- Main Tube: 50×50×1.5mm
- Meas: 108×18×14cm
- N.W./G.W.: 14/16kgs



**MD6221 10PRS DUMBBELL STORAGE RACK**

- Main Tube: 40×80×1.5mm
- Meas: 122×53×30cm
- N.W./G.W.: 27/29kgs



**MD6223 DUMBBELL STORAGE RACK**

- Meas: A-157×27×32cm, B-95×50×12.5cm
- N.W./G.W.: 46/50kgs



**MD6213 10PRS DUMBBELL STORAGE RACK**

- Main Tube: 50×70×2.0mm
- Meas: 127×18×14cm
- N.W./G.W.: 21/23kgs



**MD6214 10PRS DUMBBELL STORAGE RACK**

- Meas: 127.5×56.5×28cm
- N.W./G.W.: 21/24kgs



**MD6224 10PRS DUMBBELL STORAGE RACK**

- Main Tube: 40×80×2mm
- Meas: A-185×25×18cm, B-93×80×27cm
- N.W./G.W.: 70/74kgs



**MD6225 KETTLEBELL STORAGE RACK**

- Main Tube: 40×80×2mm
- Meas: 32×54×22cm
- N.W./G.W.: 44/46kgs



**MD6226 KETTLEBELL STORAGE RACK**

- Main Tube: 30×60×1.5mm
- Meas: 32×54×22cm
- N.W./G.W.: 44/46kgs



**MD6227 KETTLEBELL STORAGE RACK**

- Main Tube: 50×50×1.8mm
- Meas: A-150×30×8.5cm, B-86.5×67×12cm
- N.W./G.W.: 33/36.5kgs



**MD6228 KETTLEBELL STORAGE RACK**

- Main Tube: 40×60×2mm
- Meas: A-144×33×14cm, B-79×66×18cm
- N.W./G.W.: 36/39kgs



**MD6229 X-STYLE DUMBBELL STORAGE RACK**

- Main tube: 60x1.5cm
- Assembly Size: 70x60x120cm
- Meas: 128.5x64x12.5cm
- N.W./G.W.: 20/22kgs



**MD6230 DUMBBELL STORAGE RACK**

- Main Tube: 40×80×2mm
- Meas: A-185×25×18cm, B-93×80×27cm
- N.W./G.W.: 70/74kgs



**MD6231 10PRS DUMBBELL STORAGE RACK**

- Main Tube: 50x100x2mm
- Meas: A-247×30×14cm, B-89x74x25cm
- N.W./G.W.: A-53/56kgs, B-28.5/30.5kgs



MD6301



MD6305



MD6308



MD6304

**MD6301 BARBELL RACK (10 BARBELLS)**

- Packing: 1pc/ctn
- Main Tube: 50x50x1.5mm
- Meas: 130x78x11.5cm
- N.W./G.W.: 31/33kgs

**MD6305 20 PUMP SET CLUB RACK**

- Packing: 1set/2ctn
- Main Tube: 40x40x1.5mm
- Meas: A-116x74x28cm
- B-105x30x24.5cm
- N.W./G.W.: A-22/24kgs B-14/16kgs

**MD6304 BARBELL RACK (10 BARBELLS)**

- Main Tube: PT50x100x2.5mm Packing: 1pc/ctn
- Meas: 172x89x25cm N.W./G.W.: 67/70kgs
- Main Tube: PT40x80x2mm Packing: 3pc/ctn
- Meas: 139x89x25cm N.W./G.W.: 33/40kgs

**MD6308 AEROBIC BAR STORAGE RACK**

- Packing: 1pc/ctn Meas: 185x80x15.5cm
- N.W./G.W.: 57/59kgs

**MD6311 20 PUMP SET CLUB RACK**

- Packing: 1set/2ctn
- Main Tube: 50x100x1.5mm
- Meas: A-177x45x17cm
- B-167x72x23cm
- N.W./G.W.: A-46/48kgs, B-43/46kgs.

MD6311

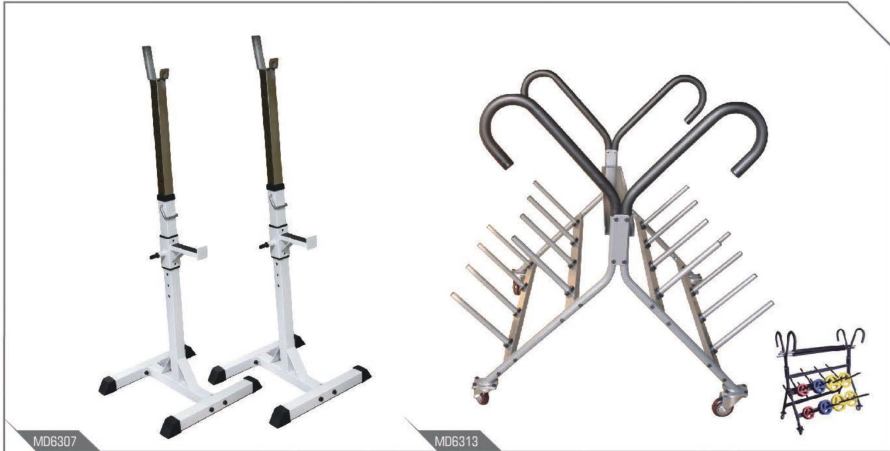

MD6307

MD6313



MD6309

MD6312

MD6320

**MD6307 INDEPENDENT SQUAT STANDS**

- Main Tube: 50x50x2.0mm
- Packing: 1set/2ctn
- Meas: (107x45x19cm)x2
- N.W./G.W.: 20/23kgs

**MD6309 AEROBIC BAR STORAGE RACK**

- Packing: 1pc/ctn
- Meas: 99.5x61x22cm
- N.W./G.W.: 13.5/14.5kgs

**MD6312 BODY BAR STORAGE RACK**

- Packing: 1set/2ctn
- Meas: A-146x42x29cm  
B-73x68.50x9cm
- N.W./G.W.: A-13/14kgs, B-7.5/8.5kgs

**MD6313 PUMP SET STORAGE CART**

- Packing: 1pc/ctn
- Meas: 140x52x27cm
- N.W./G.W.: 33/35kgs

**MD6320 BARBELL RACK**

- Main Tube: 50x100mm
- Packing: 1pc/ctn
- Assembly Size: 84x54x123cm
- Meas: 140x 86.5x14.5cm
- N.W./G.W.: 33.0/10.0kgs



MD6317

MD6315



MD6310

MD6314

**MD6310 BAR HOLDER (8 BARS)**

- Packing: 1pc/ctn
- Size: steel plate thickness 18mm
- Meas: 44x44x17cm
- N.W./G.W.: 20.5/21.5kgs

**MD6314 BAR HOLDER**

- Packing: 1pc/ctn
- Meas: 62x62x20cm
- N.W./G.W.: 29.5/31kgs

**MD6318 BAR HOLDER**

- Packing: 1pc/ctn
- Meas: 45x45x21cm
- N.W./G.W.: 21.8kg/22.8kgs

**MD6315 SQUAT STAND**

- Packing: 1pc/ctn
- Meas: 105x53x13cm
- N.W./G.W.: 18.5/20kgs

**MD6317 SQUAT STAND (NO BARBELL)**

- Packing: 1pc/ctn
- Meas: 191x46.5x16cm
- N.W./G.W.: 74.5kg/77.5kgs

**MD6319 DEEP SQUAT TRAINING RACK**

- Packing: 1pc/ctn
- Meas: 53x32x15cm
- N.W./G.W.: 9.0/10.0kgs

MD6314

MD6319



MD6322

**MD6321 WALL MOUNTED BAR RACK**  
 • for 6 bars

**MD6322 BARBELL SUPPORTER**  
 • for olympic barbell

**MD6323 BARBELL RACK**  
 • for 5pcs barbell  
 • Meas: 165 x 80 x 15cm  
 • N.W./G.W.: 38/40kgs

**MD6316 BARBELL RACK (10 BARBELLS)**  
 • Main Tube: 120\*40\*2mm  
 • Packing: 1pc/ctn  
 • Meas: 139\*95\*30cm  
 • N.W./G.W.: 50/52kgs

MD6321



MD6316



MD6323



MD6401

MD6401A

MD6402

**MD6401/MD6401A 10 MEDICINE BALL STAND**  
 • Packing: 1set/2ctns  
 • Meas: 153\* 15\* 15cm/48.5\* 43\* 32cm  
 • N.W./G.W.: 12/15kgs

**MD6402 5 MEDICINE BALL STAND**  
 • Packing: 1set/2ctns  
 • Meas: A-153\* 15\* 15cm  
 • B-48.5\* 43\* 32cm  
 • N.W./G.W.: 9/12kgs

**MD6403 MEDICINE BALL RACK**  
 • Main Tube: 40\*80\*1.5mm  
 • Packing: 1pc/ctn  
 • Meas: 149\* 36\* 12cm  
 • N.W./G.W.: 21/23kgs

**SQUAT STAND & BALL RACKS**

**MD6405 10 MEDICINE BALL RACK**  
 • Packing: 1pc/ctn  
 • Meas: 157\* 40\* 26cm  
 • N.W./G.W.: 17/18.5kgs



**MD6404 9 BALL STORAGE TREE**  
 • Packing: 1pc/ctn  
 • Meas: 142\* 142\* 22cm  
 • N.W./G.W.: 25/27kgs





MD6408



MD6409



MD6411



MD6412



MD6416

**MD6408 24 MEDICINE BALL RACK**

- Packing: 1set/2ctns
- Meas: A-172\* 17\* 15.5cm
- N.W./G.W.: 26.5/28kgs
- B-48.5\* 43\* 32cm
- N.W./G.W.: 10.5/12kgs

**MD6409 5 MEDICINE BALL STAND**

- Packing: 1pc/ctn
- Meas: 159\* 34\* 15cm
- N.W./G.W.: 10.5/12kgs

**MD6411 4 MEDICINE BALL STAND**

- Packing: 1pc/ctn
- Meas: 121\* 36\* 15cm
- N.W./G.W.: 7.5/8.5kgs

**MD6412 5 MEDICINE BALL STAND**

- Packing: 1pc/ctn
- Meas: 157\* 44\* 15cm
- N.W./G.W.: 9/10kgs

**MD6416 16 BALL STORAGE TREE**

- Packing: 1pc/ctn
- Meas: 97\*86\*35cm
- N.W./G.W.: 38.0/40.0kgs

**MD6413 MEDICINE BALL RACK**

- Main Tube: 40\*80\*1.5mm
- Packing: 1pc/ctn
- Meas: 149\* 36\* 12cm
- N.W./G.W.: 2.1/2.3kgs

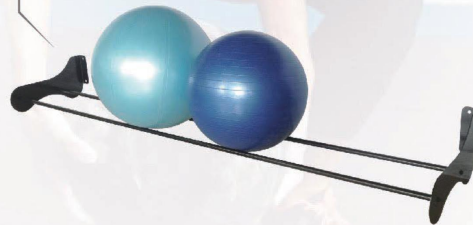

**MD6410 MEDICINE BALL REACTOR**

- Packing: 1pc/ctn Meas: 104\*100\*25cm
- N.W./G.W.: 26.0/28.0kgs



**MD6415 6 BALL STORAGE RACK**

- Main Tube: 25\*1.2mm
- Assembly Size: 159\*50\*183cm
- Meas: 187\*57\*12cm
- N.W./G.W.: 17.6/19.6kgs



MD6414



MD6419

**MD6414 4 BALL STORAGE RACK**

- Main Tube: 25\*1.2mm
- Assembly Size: 159\*50\*107cm Packing: 1pc/ctn
- Meas: 167\*55\*10cm
- N.W./G.W.: 20.0/21.0kgs

**MD6419 STORAGE CART FOR MEDICINE BALL**

- Packing: 1pc/ctn
- Meas: 124\*86\*13cm
- N.W./G.W.: 48.0/50.0kgs

**MD6418 9 BALL STORAGE RACK**

- Packing: 1pc/ctn
- Meas: 235\*80\*40cm
- N.W./G.W.: 40.0/44.0kgs



MD6418

**MD6421 SWISS BALL TREE**

- 2.5x2.5cm base tube in black + 30mm D Pole in chrome plated.
- 5 pcs x 41-42cm Circle / 12.5mm D Ring & 8mm D support + 5 pcs x 31.5cm Circle, 12.5mm D Ring & 8mm D support
- Meas: 102x102x13cm
- N.W./G.W: 17.5/18kgs



**MD6420 MEDICINE BALL STORAGE CART**

- (for 20pcs medicine ball)
- Main Tube: PT30\*70\*15mm
- Packing: 1pc/ctn
- Meas: 80\*80\*19cm
- N.W./G.W: 34.3/36.7kgs



**MD6417 MINI TRAMPOLINE**

- size: 36"/38"/40"/48"
- Packing: 1pc/ctn

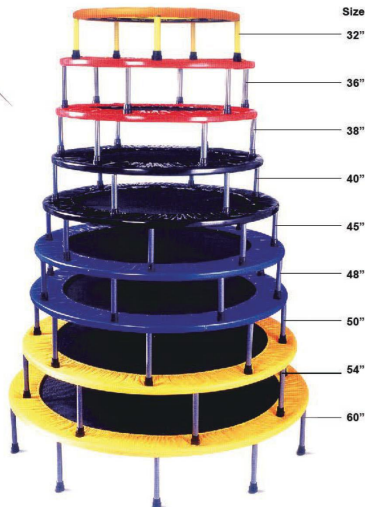

- Size
- 32"
- 36"
- 38"
- 40"
- 45"
- 48"
- 50"
- 54"
- 60"

**MD6422 FOLDING TRIMPOLINE**

- 55" Hex Trampoline. Main tube  $\phi 28 \times 1.5$ mm, handle tube  $\phi 34 \times 1.5$ mm &  $\phi 30 \times 1.5$ mm, base tube  $\phi 28 \times 1.5$ mm, resistance tube D-0.8cm
- Meas: 117x69.5x13.5cm
- N.W./G.W: 12.00/14.50kgs
- Loading/20: 230sets
- Loading/40: 500sets



**MD6501 PLYO BOXES**

- 18mm T board covered with 6mm T solid non-slip rubber mat with white speckles.

Name	Description	MOQ
29x29cmx6"	5.5KGS. Main tube 25.4x25.4x1.2mm	RS0805N 10SETS
33x33cmx12"	7KGS. Main tube 25.4x25.4x1.2mm	RS0805H 10SETS
35.6x35.6cmx18"	8.5KGS. Main tube 25.4x25.4x1.2mm	RS0805I 10SETS
38.5x38.5cmx24"	10KGS. Main tube 25.4x25.4x1.5mm	RS0805J 10SETS
41.9x41.9cmx30"	13KGS. Main tube 25.4x25.4x1.5mm	RS0805K 10SETS
50.8x50.8cmx38"	16KGS. Main tube 25.4x25.4x1.5mm	RS0805L 10SETS
55.9x55.9cmx42"	18.5KGS. Main tube 25.4x25.4x1.5mm	RS0805M 10SETS

Meas: A: 6"/pc: 36.5 x 36.5 x 17.5cm, 5.5/6.3 kgs  
 B: (12", 18", 24", 30", 36", 42")/set,  
 60 x 66.5 x 109cm, 59.5/65.5 kgs



**MD6502 PLYO BOXES**

- 3cm x 3cm x 1.5mm T frame tubes powder coated + 18mm T board covered with 6mm T solid non-slip rubber mat with white speckles.

Description	MOQ
50cm x 50cm x 30cm H, 12.5 kgs	RS0809H 10SET
60cm x 60cm x 45cm H, 17.0 kgs	RS0809I 10SET
70cm x 70cm x 60cm H, 23.0 kgs	RS0809J 10SET
80cm x 80cm x 75cm H, 27.5 kgs	RS0809K 10SET



**MD6503 ADJUSTABLE PLYO BOX**

- Size: 82 x 60.5 x 30.5 (H) to 47.5cm (H)
- 3cm x 3cm x 1.5mm T frame tubes powder coated + 18mm T board covered with 6mm T solid non-slip rubber mat with white speckles.
- Meas: 80x80x28cm
- N.W./G.W: 32.5/34.5kgs
- MOQ: 10SETS



**MD6504 ADJUSTABLE LATERAL PLYO BOX**

- Plates can be put onto two end parts below surface board.
- Main Tube: 25.4 x 25.4 x 1.5mm
- Meas: 130 x 51.5 x 17cm
- N.W./G.W: 50/53 kgs
- MOQ: 10SETS



**MD6505 PLYWOOD PLYO BOXES**

• 18mm T board

Size	Meas	Ctn Size	N.W./G.W.	MOQ
40 x 50 x 60cm	1set/ctn	61.5 x 51.5 x 12.5cm	12/13 kgs	10SETS
50 x 60 x 70cm	1set/ctn	71.5 x 61.5 x 12.5cm	15.9/16.9 kgs	10SETS
51 x 60 x 76cm	1set/ctn	77.5 x 62.5 x 12.5cm	116/17 kgs	10SETS

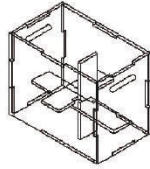

**MD6506 POWER BOX**

• 18mm T board

Size	Meas	Ctn Size	N.W./G.W.	MOQ
40 x 50 x 60cm	1set/ctn	61.5 x 51.5 x 14cm	17/18 kgs	20SETS
50 x 60 x 70cm	1set/ctn	71.5 x 61.5 x 14cm	19/20 kgs	20SETS



**MD6507 POWER BOX**

• 18mm T side boards +25mm T upper board with non-slip PET abrasive paper

Size	Meas	Ctn Size	N.W./G.W.	MOQ
56 x 56 x 30cm (single one)	1set/ctn	60 x 57.5 x 7.5cm	17/18 kgs	20SETS
56 x 56 x 60cm (double layers)	1set/ctn	60 x 57.5 x 13.5cm	19/20 kgs	20SETS



**MD6508B PLYOSOFT BOX SET**

- Made of high density foam and EPE foam 600D PVC covers for four side faces, and 1000D anti-slip PVC for upper and bottom sides.
- Boxes can be used together or individually

Size	Meas	Ctn Size	N.W./G.W.	MOQ
Level 01 900 (L) x 750 (w) x 300 (H) mm-Green	1set/ctn	910 x 760 x 310cm	16.1/17.1 kgs	10SETS
Level 02 900 (L) x 750 (w) x 450 (H)mm-Blue	1set/ctn	910 x 760 x 460cm	19.6/20.6 kgs	10SETS
Level 03 900 (L) x 750 (w) x 600 (H)mm-Red	1set/ctn	910 x 760 x 610cm	22/23 kgs	10SETS



**MD6509 JERK BLOCKS**

- Material: wooden
- 8pcs/set, 2sets/PR
- Size: 191CM x W51CM x H94CM/set
  - 1 of 4: 90 x 51 x 6cm
  - 2 of 4: 90 x 51 x 15.5cm
  - 3 of 4: 90 x 51 x 30.5cm
  - 4 of 4: 90 x 51 x 38cm
- Packing: Pallet/PR
- N.W./G.W.:160/180 kgs



**MD6508C PLYOSOFT BOX SET**

- Size: Level 01 900 (L) x 750 (w) x 150 (H) mm-Green
  - Level 02 900 (L) x 750 (w) x 300 (H)mm-Blue
  - Level 03 900 (L) x 750 (w) x 450 (H)mm-Red
  - Level 03 900 (L) x 750 (w) x 600 (H)mm-Black
- Meas: Level 01 92 x77 x 17cm, 10/11 kgs
  - Level 02 92 x 77 x 32cm, 16.1/17.1 kgs
  - Level 03 92 x 77 x 47cm, 19.6/20.6 kgs
  - Level 04 92 x 77 x 62cm, 22/23 kgs
- Made of high density foam and EPE foam 600D PVC covers for four side faces, and 1000D anti-slip PVC for upper and bottom sides.
- Boxes can be used together or individually



**MD6508 PLYOSOFT BOX SET**

- Size: Level 01 900 (L) x 750 (w) x 300 (H) mm-Green
  - Level 02 900 (L) x 750 (w) x 450 (H)mm-Blue
  - Level 03 900 (L) x 750 (w) x 600 (H)mm-Red
- Made of EPE foam with PVC cover
- Boxes can be used together or individually
- Meas: Level 01 92x77x32cm, 5/6 kgs
  - Level 02 92x77x47cm, 9/10 kgs
  - Level 03 92x77x62cm, 11/12 kgs



**MD6510 3 IN 1 SOFT PLYO BOX-BLACK**

- Dense foam with anti-slip landing zones
- Size: 75x61x51cm
- Meas: 77x63x53cm
- N.W./G.W.: 28.5/30 kgs





Olympic platform provides a dedicated space for olympic lifting. The steel frame that bolts together with gusseted corners. The rubber surface is shock absorbing and will cause less wear and tear on your equipment. It also dampens the sound when dropping a fully loaded barbell. You can use either rubber tiles or a combination of rubber and wood.

**MD6511 WEIGHT LIFTING PLATFORM (WITH HANDLES)**

- A combination of plywood and stall mats
- Size: 251 x 191 x 5cm, main tube for steel frame (bolt-together): 50 x 50 x 3mm, rubber tiles (6pcs) - 60 x 60 x 3cm, wooden board - 120 x 180 x 3cm



**MD6511A WEIGHT LIFTING PLATFORM (WITH HANDLES)**

- Size: 251 x 131 x 5cm, main tube for steel frame (bolt-together): 50 x 50 x 3mm, rubber tiles (8pcs) - 60 x 60 x 3cm



**MD6511B WEIGHT LIFTING PLATFORM**

- Size: 251 x 191 x 5cm, main tube for steel frame (bolt-together): 50 x 50 x 3mm, rubber tiles (12pcs) - 60 x 60 x 3cm



**MD6511C WEIGHT LIFTING PLATFORM**

- Size: 251 x 251 x 5cm, main tube for steel frame (bolt-together): 50 x 50 x 3mm, rubber tiles (16pcs) - 60 x 60 x 3cm



**MD6601 SPEED SLED**

- Main Tube: PT40 x 80 x 2mm
- Meas: 108 x 49 x 21cm
- N.W./G.W.: 21/23 kgs

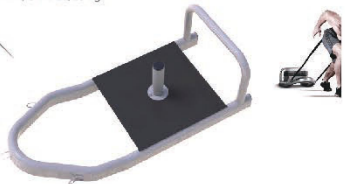

**MD6602 SPEED SLED**

- Main Tube: PT40 x 80 x 2mm
- Meas: 108 x 49 x 21cm
- N.W./G.W.: 21/24 kgs



**MD6603 TRUNK BLASTER BASE**

- Size: base plate 10mm (thickness)
- Meas: 53 x 44 x 13cm
- N.W./G.W.: 21/23 kgs



**MD6604 DELUXE POWER SLED**

- Main Tube: 80 x 80 x 3mm, 50 x 70 x 3mm, tubing 60 x 60 x 2mm T,
- plate sled 4mm / 6mm T with chromed OP bar
- Meas: 85 x 44 x 16cm N.W./G.W.: 38/39 kgs
- tubing 50 x 50 x 2mm T with painted OP bar
- tubing 50 x 50 x 2mm T with chromed OP bar



**MD6605 TRUNK BLASTER BASE**

- Size: base plate 405 X 482 X 10mm, tubing 32mm OD x 3mm T (26mm ID) & 63.5mm OD x 6mm T (51.5mm ID)
- Meas: 56 x 48 x 18cm N.W./G.W.: 23/25 kgs



**MD6606 EMLACEMENT RACK**

- Main Tube: 80x80x3mm, 50x70x3mm
- Meas: 85 x 44 x 16cm
- N.W./G.W.: 38/39 kgs

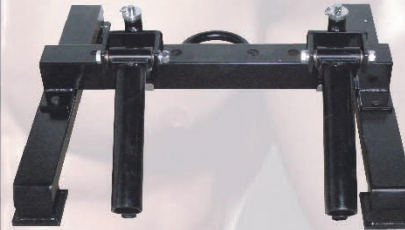

**MD6607 SPEED SLED**

- Base size: 600 x 400 x 5mm, without harness



**MD6608 POWER SLED**

- Main tube: 60 x 60 x 3mm, Ø48x2mm and Ø46x2mm
- Assembly size: 100 x 61 x 98cm
- Meas: 103 x 56 x 21cm
- N.W./G.W.: 35/37 kgs



**MD6609 POST LANDMINE**

- Main Tube: Ø50x3mm, Ø57x4mm
- Base Post Length: 7.25"
- Pivot-Sleeve Length: 10"
- Popular upright barbell / landmine exercises: landmine press, landmine row, bent over row, push press, push jerk, deadlift, cleans, standing barbell Russian Twist



**MD6705 HANGING MAT RACK**

- Size: steel board 640 x 60 x 5mm
- Meas: 2pcs/inner box, 10pcs/ctn
- Ctn Size: 67 x 40 x 23cm
- N.W./G.W.: 18/20kgs



**MD6711 ADJUSTABLE EXERCISE MAT RACK**

- Meas: 68 x 12 x 4.5cm
- N.W./G.W.: 3.0/3.5kgs



**MD6701 / MD6701A STANDING MAT RACK**

- Centres of hanging rods are 508mm and diameter of hanging rods is 19mm
- Main Tube: 40 x 80 x 1.5mm
- Meas: 196 x 76 x 18cm
- N.W./G.W.: 18/20kgs

•With adjustable bars on both sides



**MD6703 TRX RACK-2M**

- Assembly size: 307x256x250cm
- Packing: wooden case
- LOGO: laser



**MD6704 TRX RACK-3M**

- Assembly Size: 407x256x250cm
- Meas: A-163 x 34 x 13cm 28/36kgs
- B-173 x 33 x 13cm 28/40kgs
- C-150 x 62 x 46cm 29/31kgs
- D-150 x 62 x 46cm 24/26kgs
- Packing: wooden case
- LOGO: laser



**MD6706 TRX MOUNT**

- D12cm or 18cm, with bolts
- Meas: 10 pcs/ctn
- Ctn Size: 41 x 21 x 44cm
- N.W./G.W.: 16/17 kgs



**MD6707 PUNCH BAG MOUNT**

- With bolts
- Meas: 30 pcs/ctn
- Ctn Size: 39 x 34 x 34cm
- N.W./G.W.: 26/26.6 kgs



MD6708



MD6709



MD6710

**MD6708 MAT RACK**

- Main Tube: 25 x 1.2mm
- Assembly Size: 99 x 73 x 113cm
- Meas: 116 x 79 x 10cm
- N.W./G.W.: 12.80/14.80kgs

**MD6709 MAT RACK**

- Main Tube: 25 x 1.2mm
- Assembly Size: 61 x 61 x 71cm
- Meas: 67 x 68 x 11cm
- N.W./G.W.: 12.60/13.60kgs

**MD6710 MAT RACK**

- Main Tube: 38 x 1.2mm, 32 x 2mm
- Assembly Size: 87 x 112 x 68cm
- Meas: 110 x 72 x 20cm
- N.W./G.W.: 14.20/16.20kgs

**MD6712 MAT RACK**

- Adjustable length: 37-53cm
- The length of bracket: 25cm
- Packing: 1pc/inner box
- Meas: 10pcs/ctn
- Ctn Size: 68 x 46 x 13cm
- N.W./G.W.: 21.0/23.0kgs



**MD6713 POWER LOOP RACK**

- Main Tube: F40 x 1.5mm, φ16\*1.5mm
- Assembly Size: 60 x 60 x 1.90cm



**MD6713A POWER LOOP RACK**

- Main Tube: 40 x 80 x 2mm, φ22\*1.5mm
- Assembly Size: 80 x 70 x 182cm



**MD6801 MACHINE BAR RACK**

- Meas: 128 x 57 x 28cm
- N.W./G.W.: 15/17kgs



**MD6802 PORTA BARS**

- Main Tube: D50x2mm, 42x2mm
- Meas: 70 x 80 x 15cm
- N.W./G.W.: 10/11kgs



**MD6803 WALL MOUNTED DIP BARS**

- Meas: 53 x 32 x 15cm
- N.W./G.W.: 9/10kgs



**MD6810 FOAM ROLLER RACK**

- Meas: 93 x 60 x 22cm
- N.W./G.W.: 13.5/15kgs



**MD6806 WEIGHT BAG RACK**

- Main Tube: PT 40 x 80 x 1.5cm
- Meas: 170 x 70 x 24cm
- N.W./G.W.: 20/22kgs

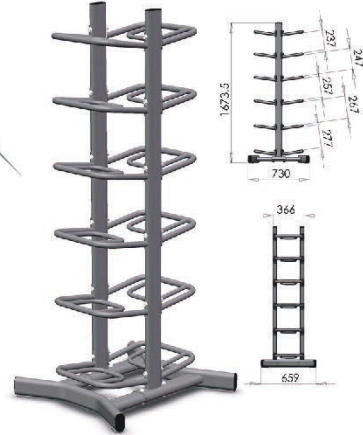

**MD6814 PARALLETES**

- Meas: 61 x 38 x 9cm
- N.W./G.W.: 6/7kgs



**MD6812 BOSU BALL RACK**

- Meas: A-178 x 15.5 x 10cm
- B-64 x 60 x 8cm
- N.W./G.W.: 23/28kgs



**MD6809 BOSU BALL RACK**

- Bosu Size: D 61cm, H 25.4cm
- Main Tube: 30 x 30 x 1.5mm
- Assembly Size: 123 x 56 x 197cm
- Meas: 177 x 62 x 23cm
- N.W./G.W.: 35.80/37.80kgs



**MD6808 BOSU BALL RACK**

- Meas: 154 x 77 x 15.5cm
- N.W./G.W.: 18/20.5kgs



**MD6807 WEIGHT BAG RACK (5 LAYERS)**

- Main Tube: PT 40 x 80 x 1.5cm

**MD6807 WEIGHT BAG RACK (5 LAYERS)**

- Main Tube: PT 40 x 80 x 1.8cm(with printing board)
- Assembly Size: 80 x 64 x 167.5cm

**MD6807 WEIGHT BAG RACK (6 LAYERS)**

- Main Tube: PT 40 x 80 x 1.5cm
- Meas: 173 x 70 x 30cm, 68 x 75 x 6cm
- N.W./G.W.: 24.5/26.5kgs



MD6807

**MD6811 STEP/RAISER CART**

- Main Tube: 32 x 2mm
- Assembly Size: 215 x 49 x 142cm
- Meas: 218 x 65 x 20cm
- N.W./G.W.: 38.00/40.00kgs



**MD6815 STORAGE RACK**

- Length: 450cm
- For bumper plate, kettlebells, dumbbell, power loops, wall balls, jump ropes, and slam balls
- Packing: wooden box/set
- N.W./G.W.: 250/300kgs
- Assembly Size: 449 x 50 x 200cm



Sizes available: **140cm-100cm**

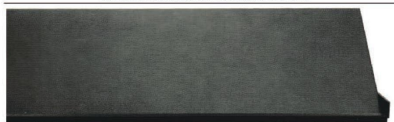

Dumbbells rack



Kettlebells rack



Wallballs - Bumpers - Slam balls rack



Elastic bands - Ropes - Jump ropes rack



**MD7019 SIT-UP BENCH**

- Main Tube: 50x100x2mm
- Meas: 142x51x42cm
- N.W./G.W.: 22/24kgs



**MD7020 ROMAN CHAIR**

- Main tube: 70x50x2mm
- Assembly size: 165x82x139cm
- Meas: A: 162x82x15cm, B: 94x56x18cm
- N.W./G.W.: 54.00/58.00kgs



**MD7013 SIT-UP BENCH**

- Main Tube: 50x100x2mm
- Assembling Size: 135x50x48-120cm
- Ctn size: 151x73x48cm
- N.W./G.W.: 44/46kgs FCL20:220PCS



**MD7005 FLAT BENCH**

- Packing: 1set/ctn
- Ctn Size: 127x43x16.5cm
- N.W./G.W.: 16.0/19.0kgs



**MD7018 SIT UP BENCH**

- Packing: 1set/ctn
- Ctn Size: 131x41x16cm
- N.W./G.W.: 15/16.3kgs



**MDAB704 TOTAL CORE**

- CTN Size:54.5\*17\*44cm
- N.W./G.W.:6.5/7.5kgs



**MDAB709 INVERSION TABLE**

- CTN Size:132\*77.5\*14cm
- N.W./G.W.:22.5/24.5kgs



**MDAB707 LEG TRAINER**

- CTN Size:61\*22\*50cm
- N.W./G.W.:8/9.5kgs



**MDAB705 AB KING**

- CTN Size:54.5\*17\*44cm
- N.W./G.W.:6.5/7.5kgs



**MDAB707 AB COASTER**

- CTN Size:128\*39.5\*39.5cm
- N.W./G.W.:28/31kgs



**MDAB701 AB ROLLER**

- Package: 5pcs/ctn
- Ctn size: 73\*37\*62cm
- N.W./G.W.: 20/22kgs



**MDAB702 AB ROLLER**

- Package: 5pcs/ctn
- Ctn size: 74\*40\*38cm
- N.W./G.W.: 21/23kgs



**MDB809 WEIGHT BENCH**

- Main Tube: 50\*50\*1.5mm
- Packing: 1pc/ctn
- Meas: 129\*62\*19cm
- N.W./G.W.: 36.4/38.5kgs



**MD8810 MULTI-FUNCTION WEIGHT BENCH**

- Main Tube:60\*30\*1.5mm,
- φ60\*1.5mm,φ50\*1.5mm
- Packing: 1pc/ctn
- Meas: 169\*62\*19cm
- N.W./G.W.: 45.8/48.7kgs



**MDB805 DELUXE BENCH**

- Main Tube:50\*50\*1.5mm
- CTN Size:107\*47\*17cm
- N.W./G.W.:20/23kgs



**MDB807 DELUXE BENCH**

- Main Tube:76\*1.75mm
- CTN Size:182\*142\*92-127cm
- N.W./G.W.:50/55kgs



**MDB808 DELUXE BENCH**

- Main Tube:76\*1.5mm
- CTN Size:187\*54\*22cm
- N.W./G.W.:53/55kgs



**MDB804 WEIGHT BENCH**

- Main Tube:50\*50\*1.5mm
- CTN Size:118\*55\*25cm
- N.W./G.W.:20/22kgs



**MDB805 WEIGHT BENCH**

- Main Tube:70\*30\*1.5mm
- CTN Size:107\*47\*17cm
- N.W./G.W.:20/23kgs

**MDB405 POWER CAGE**

- Main Tube: 75x75x2mm
- Packing: 1pc/3ctns
- A: 194.5 x 20 x 16.5cm, 33/35 kgs
- B: 133.5 x 32 x 10.5cm, 33/35 kgs
- C: 106.5 x 62.5 x 11cm, 28/33.4 kgs



**MDB403 POWER CAGE**

- Main tube: 75 x 50 x 2mm
- Packing: 1pc/4ctns
- A: 240L x 54W x 13.5H, 42.7/46 kgs
- B: 204L x 24W x 8.5H, 43.3/44.6 kgs
- C: 129L x 39.5W x 14.5H, 45.5/46.5 kgs
- D: 204L x 42W x 17.5H, 47.6/50.4 kgs



**MDB202 AB TOWER**

- Main tube: 50 x 50 x 2mm
- Meas: 169 x 46 x 21cm
- N.W./G.W.: 50/52 kgs



**MDB404 POWER CAGE**

- Main Tube: 75 x 75 x 2mm
- Packing: 1set/4ctns
- A: 204.5 x 38.5 x 9cm, 38/40 kgs
- B: 142 x 47 x 11cm, 36/38 kgs
- C: 119 x 41 x 16.5cm, 27.4/29.4 kgs
- D: 120 x 46 x 9.5cm, 34.9/36.9 kgs